

ELEUTHERA ISL SHORES

\$40,000



Address:	WILD ORCHID ROAD, Gregory Town
City:	Eleuthera
MLS#:	67260
Lot Size:	10,800 sq. ft.
Listing No:	R53
Beds:	0
Baths:	0
Living Area:	10,800 sq. ft.
Year Built:	n/a
Status:	For Sale only

PROPERTY GALLERY

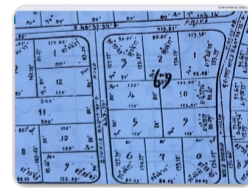
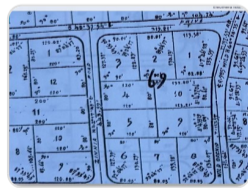

PROPERTY DETAILS

Build your dream island getaway on this oversized vacant lot located in the quiet community of Eleuthera Island Shores, Eleuthera, Bahamas. Just minutes away from Gregory Town and Surfer's Beach, this property offers a great opportunity for a private residence, vacation home, or investment property surrounded by the natural beauty and laid-back charm of Eleuthera. Conveniently located near beautiful beaches, boating, fishing, and local amenities, this property is the perfect place to enjoy island living. The North Eleuthera Airport is approximately 20 minutes away.

AGENT DETAILS



Nassau/New Providence Office

📱 [\(242\) 362-5219](tel:(242)362-5219)

☎ [\(242\) 362-5219](tel:(242)362-5219)

✉ info@moskorealty.com



The Bahamas Real Estate Association is not responsible for the accuracy of the information listed above. The data relating to the real estate for sale or lease on this website comes in part from the Internet Data Exchange Program (IDX) and the Bahamas MLS, and is provided here for consumer's personal, non-commercial use. It may not be used for any purpose other than to identify prospective properties consumers may be interested in purchasing or leasing. Real Estate listings held in brokerage firms other than the office owning this website are marked with the IDX logo on the short inquiry. Data provided is deemed reliable but not guaranteed. This information is protected by copyright and all rights reserved. This property is shown courtesy of The Bahamas MLS.

© 2026 Mosko Realty. All rights reserved.

Generated on: 06/03/2026 10:22:43 PM