

## EASTWOOD, PRINCE CHARLES DRIVE

**\$115,000**



<b>Address:</b>	EASTWOOD, Prince Charles Drive
<b>City:</b>	New Providence/Paradise Island
<b>MLS#:</b>	64032
<b>Lot Size:</b>	7,000 sq. ft.
<b>Listing No:</b>	R2086
<b>Beds:</b>	0
<b>Baths:</b>	0
<b>Living Area:</b>	7,000 sq. ft.
<b>Year Built:</b>	n/a
<b>Status:</b>	For Sale only

### PROPERTY GALLERY

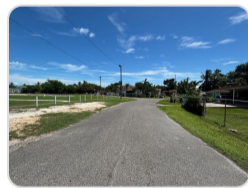
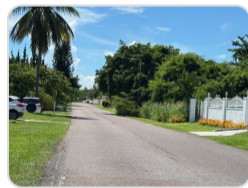

### PROPERTY DETAILS

Single family lot in the beautiful and quiet community of Eastwood now available for sale. Centrally located and within close proximity to Prince Charles Drive, Sans Souci and Camperdown neighborhoods. It's priced to sell so call now to make it yours before its too late!

### AGENT DETAILS



## Nassau/New Providence Office

 [\(242\) 362-5219](tel:(242)362-5219)

 [\(242\) 362-5219](tel:(242)362-5219)

 [info@moskorealty.com](mailto:info@moskorealty.com)



The Bahamas Real Estate Association is not responsible for the accuracy of the information listed above. The data relating to the real estate for sale or lease on this website comes in part from the Internet Data Exchange Program (IDX) and the Bahamas MLS, and is provided here for consumer's personal, non-commercial use. It may not be used for any purpose other than to identify prospective properties consumers may be interested in purchasing or leasing. Real Estate listings held in brokerage firms other than the office owning this website are marked with the IDX logo on the short inquiry. Data provided is deemed reliable but not guaranteed. This information is protected by copyright and all rights reserved. This property is shown courtesy of The Bahamas MLS.

© 2026 Mosko Realty. All rights reserved.

Generated on: 01/02/2026 01:10:03 AM