

SAN SALVADOR OCEANFRONT ACREAGE

\$499,000



Address:	Queens Highway Southwest Coast /Southwards of
City:	San Salvador
Lot Size:	88,078 sq. ft.
Listing No:	16-392
Beds:	0
Baths:	0
Living Area:	0 sq. ft.
Year Built:	n/a
Status:	For Saleonly

PROPERTY GALLERY

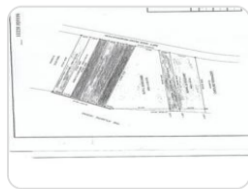

PROPERTY DETAILS

This ocean front property is located immediately Southwards of Sugar Loaf which is a 2 minute walk from the main Queen's Highway. Sugar Loaf Beach is Isolated, which is perfect for a romantic hide away or family picnics. Located on the Southwest Coast of the island of San Salvador. This parcel of land is perfect to build your celebrity home away from home.

AGENT DETAILS



The Bahamas Real Estate Association is not responsible for the accuracy of the information listed above. The data relating to the real estate for sale or lease on this website comes in part from the Internet Data Exchange Program (IDX) and the Bahamas MLS, and is provided here for consumer's personal, non-commercial use. It may not be used for any purpose other than to identify prospective properties consumers may be interested in purchasing or leasing. Real Estate listings held in brokerage firms other than the office owning this website are marked with the IDX logo on the short inquiry. Data provided is deemed reliable but not guaranteed. This information is protected by copyright and all rights reserved. This property is shown courtesy of The Bahamas MLS.

© 2026 Mosko Realty. All rights reserved.

Generated on: 06/04/2026 02:09:40 AM